

200 ULTIMATE SOUND CONTROL MEMBRANE

DESCRIPTION

PROFLEX™ 200 USC is the newest generation of sound reduction membranes providing all the benefits of a cork underlayment without the drawbacks. The cork is a highly flexible, engineered material that will be resistant to water and mold.

PROFLEX™ 200 USC is a self-bonding, reinforced 200 mil-thick engineered elastomeric/cork composite membrane that provides superior sound reduction and crack isolation.

TYPICAL USES AND BENEFITS

PROFLEX™ 200 USC is specially engineered to be used under thinset and mud set mortars and adhesives for interior applications of ceramic tile, stone, and brick, and wood flooring. PROFLEX™ 200 USC bridges cracks and controls joints up to 3/8" wide, eliminating the transfer of cracks to the finished flooring. To completely eliminate cracks in finished floor work, the product should be applied to the entire substrate prior to the installation of the finished flooring. When used with PROFLEX™ RST (Rubber seam tape) PROFLEX™ 200 USC provides protection against moisture vapor transmission of up to 5#/1000sq.ft./ 24 hours (as tested with a CaCl test kit). Other flooring applications also may be suitable. Contact technical support for additional information.

ADVANTAGES

- Easy and fast to install with standard tools
- Ready for tiling immediately after installation
- Crack and joint isolation up to 3/8"
- Superior Sound reduction
- May be installed on grade with Proflex™ RST
- Compatible with wood adhesives

SUITABLE SUBSTRATES

- Concrete
- Cement terrazzo
- Cement backer board
- Urethane membranes, fiberglass decks, other materials (contact technical support)
- Mortar beds
- Exterior-grade plywood
- Tile

MEMBRANE AND PRIMER PACKAGING

PROFLEX™ 200 USC
3'X 25' rolls, 75 sq ft/roll, 20 rolls/pallet

PROFLEX™ Primers

PR10, water-based, 1-gallon can
PR11, water-based, 1-gallon pail
PR27, solvent-based, 1-gallon can
Approximate coverage: 300-500 sq ft/gallon

MEMBRANE AND PRIMER SHELF LIFE

PROFLEX™ 200 USC: Factory-sealed containers of this product are guaranteed to be of first quality for one (1) year if stored at temperatures between 32°F and 110°F.

PROFLEX™ Primers: Shelf life of one (1) year when stored at temperatures between 45°F and 110°F

200 USC Ultimate Sound Control Membrane Data Sheet

TECHNICAL DATA

Physical Properties

Property	Test Method	Results
Total thickness		200 mils
Cork thickness		130 mils
Elongation	ASTM D882	350% min
Tensile MD	ASTM D1682	1270 psi
Pliability	ASTM D146	Pass-25
Adhesion to plywood	ASTMD1790	8 lb/in
Adhesion to primed concrete	ASTM D903	10 lb/in
Delta IIC	ASTM E2179	20
Robinson test	ASTM C627	Light commercial
Standard Range:		High Tensile Floor Underlayment
Binder		Polyurethane
Granual Size		2-4mm
Density Minimum		160 (10.0) Kg/m3 (pcf)
Compression %		35-50
Recovery Minimum %		75
Tensile Strength*		L-55
Flexibility		F-5
Test Method:	ISO 7322-86	
	NP 2372-84	
Classification:	ISO 4714-86	
	NP 3004-88	

(*) L-Longitudinal Test
T-Transversal test

SEE REVERSE FOR INSTALLATION REQUIREMENTS AND LIMITATIONS

Proflex Products, Inc.
3406 Dean Street Naples, FL 34104
877-5PROFLEX Fax: 877-283-1511

For additional technical Support,
Contact 877-538-3437
www.proflexcism.com

200 ULTIMATE SOUND CONTROL MEMBRANE

State of the Art Sound Reduction and Crack Isolation Membrane

PROFLEX 200 USC SOUND REDUSSION SYSTEM

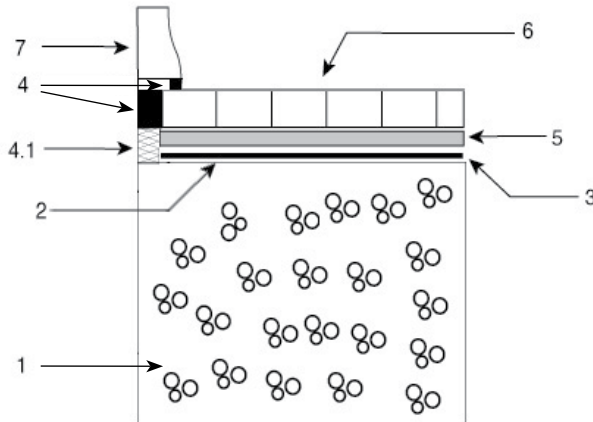

MATERIALS (REFER TO DRAWING ABOVE)

- (1) SUBSTRATE (COMPLYING W/ INDUSTRY STANDARDS)
- (2) PROFLEX PRIMER
- (3) PROFLEX USC
- (4) ACOUSTICAL SEALANT
- (4.1) CLOSED CELL FOAM OR BACKER ROD
- (5) THINSET OR MUD BED
- (6) SURFACE (CERAMIC, STONE, MARBLE, ETC.)
- (7) BASE BOARD

INSTALLATION REQUIREMENTS AND LIMITATIONS

- Substrate must be primed with PROFLEX™ Primer unless instructed otherwise by technical service.
- Impervious tile (less than 0.5% absorption) may require a 48-hour cure prior to grouting. The mortar will be sandwiched between two nonabsorptive materials and will require additional cure time. Cooler weather will also increase set time. Consult mortar manufacturer for additional requirements.
- Not for use over expansion joints (structural design joints) or structural (out-of-plane) movement cracks.
- Seams should have no separation for sound control applications and only 1/4" maximum for crack isolation.
- Perimeter expansion of 1/4" minimum must be maintained for warranty. Consult the TCA Handbook for other expansion joint requirements and sealant details.
- Not recommended for use on concrete floors when hydrostatic pressure is present.
- On grade applications require the use of Proflex™ RST (Rubber seam tape).
- Maximum moisture vapor pressure exposure must not exceed 5 Lbs./ 1000 Sq.ft./ 24 Hours.
- Tile or stone must be set with an ANSI 118.4 mortar.
- This product should not be stored in direct sunlight.
- Protect Primers from freezing.

Proflex Products, Inc.
3406 Dean Street Naples, FL 34104
877-5PROFLEX Fax: 877-283-1511

For additional technical Support,
Contact 877-538-3437

www.proflexcism.com



Proudly made in the U.S.A.